

TITLE REPAIR SCHEME COWL FLAP TORQUE TUBE ARM	E.M. NO. 12871	FILE CODE 111
	EFFECTIVE IMMEDIATELY	-42

PART NO. 189522	PART NAME ARM - COWL FLAP TORQUE TUBE	DWG. NO.	JOB NO.	COPIES TO	NO.										
USE OF E.M.	DISPOSITION OF STOCK	CUSTOMER'S ORDER NO.	CUSTOMER	PLANNING	SALES/CONT'S										
GALVANNE	<table border="1"> <tr> <th>CHECK STOCKS AFFECTED</th> <th>NOT AFFECTED</th> <th>USE TO DETERMINE</th> <th>SCRAP</th> <th>AS NOTED</th> </tr> <tr> <td></td> <td></td> <td></td> <td></td> <td></td> </tr> </table>	CHECK STOCKS AFFECTED	NOT AFFECTED	USE TO DETERMINE	SCRAP	AS NOTED						BREWER	RCAF	ESTIMATING	TEST FLIGHT
CHECK STOCKS AFFECTED		NOT AFFECTED	USE TO DETERMINE	SCRAP	AS NOTED										
CONDENSED		ORIGINATED BY <i>W. Richardson</i>	EXPEDITE 3	SALES/CONT'S	R.O.A.F.										
STOP ORDER/RELEASE		E. A. W. PROJ. ENG.		ESTIMATING	TEST FLIGHT										
NEW DRAWING		<i>E. Juzat</i>		ESTIMATING	TEST FLIGHT										
REVISED DRAWING		E. A. W. INSPECTION		ESTIMATING	TEST FLIGHT										
VARIATION				ESTIMATING	TEST FLIGHT										
OBsolete NOTICE				ESTIMATING	TEST FLIGHT										
USE AS NOTED <input checked="" type="checkbox"/>	INTERCHANGEABILITY AFFECTED	STRENGTH AFFECTED	DATE 10 SEP 59	DWG. CHANGE	DWG. CONT.										
	YES <input type="checkbox"/> NO <input checked="" type="checkbox"/>	YES <input type="checkbox"/> NO <input checked="" type="checkbox"/>		YES <input type="checkbox"/> NO <input checked="" type="checkbox"/>	DWG. CONT.										

APPROVALS	ENGINEERING	CONTRACTS ADMIN.	CUSTOMER
<i>[Signature]</i>	<i>[Signature]</i>	<i>[Signature]</i>	<i>[Signature]</i>

GIVE FULL PARTICULARS AND SKETCH WHERE POSSIBLE

ELONGATED HOLES IN THE FORK OF 189522 MAY BE REPAIRED AS FOLLOWS:

1. REAM HOLE $.265 \pm .001$
2. MANUFACTURE BUSHING SHOWN.
3. INSTALL BUSHINGS WET WITH ZINC CHROMATE PRIMER TO MIL-P-6889.
4. CLEAN OUT SLOT AFTER INSTALLATION

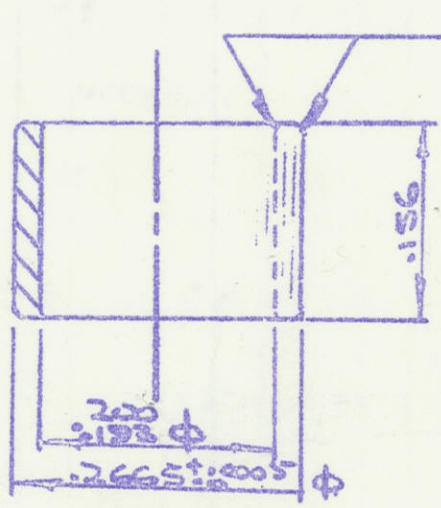

CHAMFER $.010 \times 45^\circ$

MATERIAL SAE 4130 TO MIL-S-6758
CAD PLATE TO QQ-P-46
TYPE I CLASS 2. DIM'S TO BE MET AFTER PLATING

Sept 16/59